

MEIGSVILLE TOWNSHIP SECTION 18 R11 TWP 10 MORGAN COUNTY, OHIO

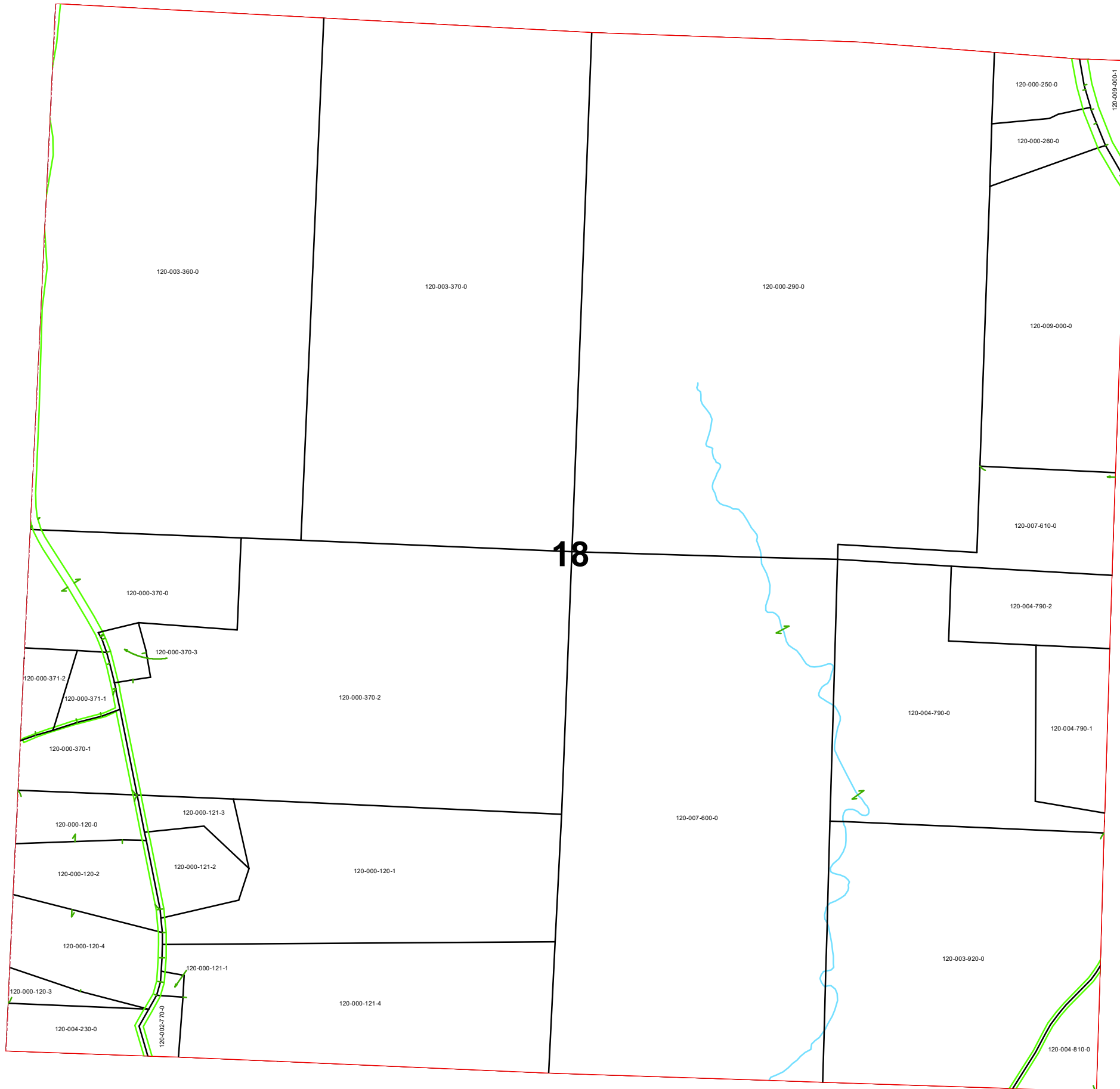

PIN	Owner	VOL	PAG	LegalDescr	Acres	Survey_Ref
120-000-370-2	ADKINS ALAN K	OR218	2742	R11 T10 S18 SD 29	63	MIG-0430.pdf
120-000-370-3	ADKINS ALAN K	OR222	2055	R11 T10 S18 SD 30	1.287	MIG-0458.pdf
120-003-370-0	ADKINS ALAN K & D KEVIN & DEMPSEY R	OR207	2786	R11 T10 S18 SD 3	82	NoSurvey.pdf
120-003-360-0	ADKINS ALAN K & D KEVIN & DEMPSEY R	OR207	2786	R11 T10 S18 SD 11	82	NoSurvey.pdf
120-000-290-0	BARNETT JOANN TRUSTEE	OR202	2088	R11 T10 S18 SD 2	120.72	NoSurvey.pdf
120-000-370-1	BOOKMAN KAY E	OR226	1119	R11 T10 S18 SD 23	4.532	MIG-0470.pdf
120-009-000-0	CAIN GERALD DEAN & THERESA	OR174	85	R11 T10 S18 SD 12	25.093	MIG-0361.pdf
120-009-000-1	CAIN GERALD DEAN & THERESA	OR174	85	R11 T10 S18 SD 24	2.214	NoSurvey.pdf
120-000-250-0	CROUSE LORA DAWN	OR234	4115	R11 T10 S18 SD 14	3.46	MIG-0289.pdf
120-000-121-4	FLAHERTY SHEA F & WENDY K	OR194	144	R11 T10 S18 SD 28	27.995	MIG-0368.pdf
120-004-230-0	HASSLER JARED J & ALLISON M	OR229	1589	R11 T10 S18 SD 16	4	NoSurvey.pdf
120-000-120-3	HASSLER JARED J & ALLISON M	OR229	1589	R11 T10 S18 SD 27	1.4	MIG-00371.pdf
120-003-920-0	HILL FRANK & DIXIE	OR209	918	R11 T10 S18 SD 7	38.61	NoSurvey.pdf
120-000-120-0	HUFFMAN KAREN M	OR229	1589	R11 T10 S18 SD 8-9	3.715	MIG-0237.pdf
120-000-260-0	JAMES DANIEL K & KLARISSA N	OR228	1155	R11 T10 S18 SD 15	3.241	MIG-0290.pdf
120-000-370-0	KEMPLE KENNETH RAY & TERESA M	OR219	626	R11 T10 S18 SD 4 S	13.09	MIG-0430.pdf
120-000-121-2	MASON DONALD B & CHARLOTTE M	OR179	395	R11 T10 S18 SD 25	4.087	MIG-0367.pdf
120-000-121-3	MASON DONALD B & CHARLOTTE M TOD	OR179	395	R11 T10 S18 SD 26	2.25	MIG-0367.pdf
120-000-120-2	MELVIN GROVER R & TIANNA J ALLEN	OR232	1148	R11 T10 S18 SD 22	6.07	MIG-0338.pdf
120-000-120-4	MELVIN GROVER R & TIANNA J ALLEN	OR232	1148	R11 T10 S18 SD 32	7.014	MIG-0467.pdf
120-000-120-1	MOOREFIELD R KEITH & REBECCA S	OR183	229	R11 T10 S18 SD 18	27.995	MIG-0368.pdf
120-004-810-0	SCHAAD RYAN C & JESSICA D	OR231	4415	R11 T10 S18 SD 10	2.89	NoSurvey.pdf
120-004-790-1	SCHAAD RYAN C & JESSICA D	OR232	2504	R11 T10 S18 SD 20	7.116	MIG-0489.pdf
120-004-790-2	SCHAAD RYAN C & JESSICA D	OR232	2504	R11 T10 S18 SD 21	7.379	MIG-0489.pdf
120-004-790-0	SCHAAD RYAN C & JESSICA D	OR232	2504	R11 T10 S18 SD 6	28.216	MIG-0489.pdf
120-007-600-0	SCOBLE BRENT	OR207	1908	R11 T10 S18 SD 5	82	NoSurvey.pdf
120-007-610-0	SCOBLE BRENT	OR207	1908	R11 T10 S18 SD 1	9.692	MIG-0379.pdf
120-000-371-2	WALLACE KAREN DENISE TOD KATIE L P	OR231	4107	R11 T10 S18 SD 33	2.164	MIG-0469.pdf
120-000-371-1	WALLACE KAREN DENISE TOD: KATIE L P	OR231	4107	R11 T10 S18 SD 31	2.008	MIG-0461.pdf
120-000-121-1	WOODYARD MICHAEL & CINDA L	OR74	148	R11 T10 S18 SD 19	0.33	MIG-0272.pdf
120-002-770-0	WOODYARD MICHAEL E & CINDA	D.V 195 300		R11 T10 S18 SD 17	1.38	MIG-0031.pdf

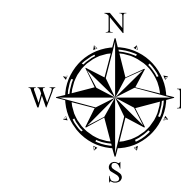

Boundaries			
	Hydro		Section
	Roads		Lot
	County		Township
	Parcel		ROW



Disclaimer: The information that these maps contains is for reference purposes only. Please bring any erros to the attention of the Engineer's Office staff. Thank you

